

Размер

∅ D ∅ B ∅ holes

DN

| Tab for 5318 B | | | Pressure | Flow rate | Action Radius | Pressure | Flow rate | Action Radius | |
|----------------|------|-----|----------|----------------------|---------------|----------|----------------------|---------------|-----------|
| mm | mm | mm | bar | m ³ /hod. | m | bar | m ³ /hod. | m | |
| 28 | 12,2 | 1,3 | 1 | 1,863 | 0,615 | 2 | 2,635 | 1,231 | 28 |
| 40 | 22,2 | 1,3 | 1 | 5,130 | 2,841 | 2 | 7,255 | 5,681 | 40 |
| 50 | 22,2 | 1,6 | 1 | 5,590 | 1,537 | 2 | 7,906 | 3,074 | 50 |
| 50 | 28,2 | 1,6 | 1 | 7,255 | 2,589 | 2 | 10,260 | 5,177 | 50 |
| 65 | 28,2 | 1,6 | 1 | 8,771 | 2,047 | 2 | 12,403 | 4,093 | 65 |
| 65 | 34,3 | 1,6 | 1 | 7,906 | 1,663 | 2 | 11,180 | 3,326 | 65 |
| 65 | 40,5 | 1,6 | 1 | 10,541 | 3,643 | 2 | 14,907 | 7,186 | 65 |
| 90 | 40,5 | 2,5 | 1 | 31,623 | 2,086 | 2 | 44,721 | 4,172 | 90 |

5318 A с резьбой 5318 B под шпильку 5318 C под сварку

Моечная головка 360°

5318

5318 B

5318 A

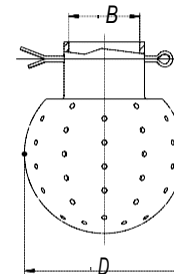
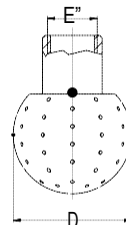

5318 C

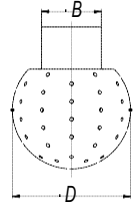

Размер

∅ D ∅ B ∅ holes

DN

| Tab for 5319 B | | | Pressure | Flow rate | Action Radius | Pressure | Flow rate | Action Radius | |
|----------------|------|-----|----------|----------------------|---------------|----------|----------------------|---------------|-----------|
| mm | mm | mm | bar | m ³ /hod. | m | bar | m ³ /hod. | m | |
| 28 | 12,2 | 1,3 | 1 | 1,863 | 0,615 | 2 | 2,635 | 1,231 | 28 |
| 40 | 22,2 | 1,3 | 1 | 5,130 | 2,841 | 2 | 7,255 | 5,681 | 40 |
| 50 | 22,2 | 1,6 | 1 | 5,590 | 1,537 | 2 | 7,906 | 3,074 | 50 |
| 50 | 28,2 | 1,6 | 1 | 7,255 | 2,589 | 2 | 10,260 | 5,177 | 50 |
| 65 | 28,2 | 1,6 | 1 | 8,771 | 2,047 | 2 | 12,403 | 4,093 | 65 |
| 65 | 34,3 | 1,6 | 1 | 7,906 | 1,663 | 2 | 11,180 | 3,326 | 65 |
| 65 | 40,5 | 1,6 | 1 | 10,541 | 3,643 | 2 | 14,907 | 7,186 | 65 |
| 90 | 40,5 | 2,5 | 1 | 31,623 | 2,086 | 2 | 44,721 | 4,172 | 90 |

5319 A с резьбой 5319 B под шпильку 5319 C под сварку

Моечная головка 270°

5319

5319 B

5319 A

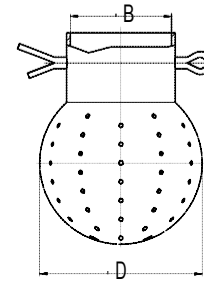
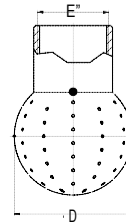

5319 C

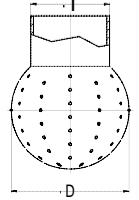

Размер

∅ D ∅ B ∅ holes

DN

| Tab for 5320 B | | | Pressure | Flow rate | Action Radius | Pressure | Flow rate | Action Radius | |
|----------------|------|-----|----------|----------------------|---------------|----------|----------------------|---------------|-----------|
| mm | mm | mm | bar | m ³ /hod. | m | bar | m ³ /hod. | m | |
| 28 | 12,2 | 1,3 | 1 | 1,208 | 1,006 | 2 | 1,709 | 2,014 | 28 |
| 40 | 22,2 | 1,3 | 1 | 3,029 | 3,875 | 2 | 4,284 | 7,752 | 40 |
| 50 | 22,2 | 1,6 | 1 | 3,471 | 2,318 | 2 | 4,909 | 4,636 | 50 |
| 50 | 28,2 | 1,6 | 1 | 4,714 | 4,275 | 2 | 6,667 | 8,550 | 50 |
| 65 | 28,2 | 1,6 | 1 | 5,345 | 2,991 | 2 | 7,559 | 5,982 | 65 |
| 65 | 34,3 | 1,6 | 1 | 6,455 | 5,366 | 2 | 5,976 | 3,739 | 65 |
| 65 | 40,5 | 1,6 | 1 | 5,872 | 4,44 | 2 | 8,305 | 8,882 | 65 |
| 90 | 40,5 | 2,5 | 1 | 12,91 | 1,375 | 2 | 18,257 | 2,750 | 90 |

5320 A с резьбой 5320 B под шпильку 5320 C под сварку

Моечная головка 120°

5320

5320 B

5320 A

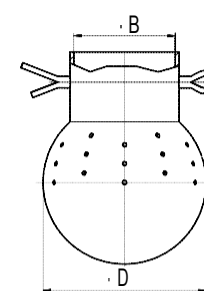
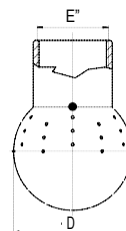

5320 C

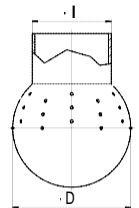

Размер

∅ D ∅ B ∅ holes

DN

| Tab for 5321 B | | | Pressure | Flow rate | Action Radius | Pressure | Flow rate | Action Radius | |
|----------------|------|-----|----------|----------------------|---------------|----------|----------------------|---------------|-----------|
| mm | mm | mm | bar | m ³ /hod. | m | bar | m ³ /hod. | m | |
| 28 | 12,2 | 1,3 | 1 | 1,208 | 1,006 | 2 | 1,709 | 2,014 | 28 |
| 40 | 22,2 | 1,3 | 1 | 3,029 | 3,875 | 2 | 4,284 | 7,752 | 40 |
| 50 | 22,2 | 1,6 | 1 | 3,471 | 2,318 | 2 | 4,909 | 4,636 | 50 |
| 50 | 28,2 | 1,6 | 1 | 4,714 | 4,275 | 2 | 6,667 | 8,550 | 50 |
| 65 | 28,2 | 1,6 | 1 | 5,345 | 2,991 | 2 | 7,559 | 5,982 | 65 |
| 65 | 34,3 | 1,6 | 1 | 6,455 | 5,366 | 2 | 5,976 | 3,739 | 65 |
| 65 | 40,5 | 1,6 | 1 | 5,872 | 4,44 | 2 | 8,305 | 8,882 | 65 |
| 90 | 40,5 | 2,5 | 1 | 12,91 | 1,375 | 2 | 18,257 | 2,750 | 90 |

5321 A с резьбой 5321 B под шпильку 5321 C под сварку

Моечная головка 180°

5321

5321 B

5321 A

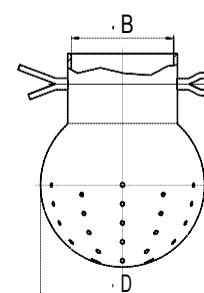
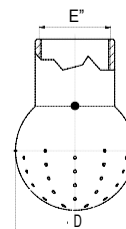

5321 C

